

**The simplest way to automate gates**

**Is to use Somfy**

from [www.openers.co.uk](http://www.openers.co.uk)

Soft start – soft stop  
Rolling code for remotes

**Somfy Axovia 400C model gate openers**

- Options include
- Battery backup
- Interface for lighting systems

[automation@openers.co.uk](mailto:automation@openers.co.uk)

## AXovia 400c Ref 1 215 036

### Sliding gate motorisation.



- **Exclusive!** With the Axovia 400C obstacle detection is guaranteed throughout the gate movement. This means that photoelectric cells are simply optional.
- **Compact and quiet for discretion.**

- **Fast opening in just a few seconds.**
- **The first cycle permits the electronics to adjust the power** to the right setting for opening and closing the gate.

#### AXOSET

Designed for easy programming and operation

- Adjustable motor speed and torque to match gate weight
- Total gate opening for vehicles and partial opening for pedestrians
- Automatic or sequential mode operation (adjustable closure time-out)

#### PACK CONTENTS

##### Pack 1 without rack Ref 1 216 005

- 1 motor
- 1 electronic control system with RTS receiver
- 2 Keytis RTS remote control units
- guide pins
- cable ducting sleeve
- 1 instruction leaflet
- 1 drilling template

##### Rack Ref 1 780 607

- 4 x 1.00 m of nylon rack with internal metal armature, low-level attachment

##### Pack 2 with rack Ref 1 215 036

- Same as Pack 1 +
- 12 x 33 cms of rack



[automation@openers.co.uk](mailto:automation@openers.co.uk)

## GATE TRAVEL

	Gate Length	
Gate Weight	1.00 m - 4.00 m	4.00 m - 8.00 m
Up to 400kg	X	X + additional rack

## TECHNICAL CHARACTERISTICS

### Motor

Mains power supply	230 V 50/60 Hz
Motor power supply	24 V
Motor power	120 W
Stand-by power consumption	4.5 W
Gate movements per day	20 cycles
Maximum thrust effort	< 15 kg
Operating temperature	- 20°C / +60°C
Thermal protection	yes
Protection index	IP54
Rack	4.16 tooth gear

### Electronics

Number of programmable remote control keys	32
Amber light socket	24 V 15 W flasher
Zone lighting socket	500 W maximum
Accessories power socket	24 Vdc / 200 mA
Back-up battery plug	yes
Photoelectric cell plug	yes (1 or 2)
Dry contact plug	yes

## DIMENSIONS

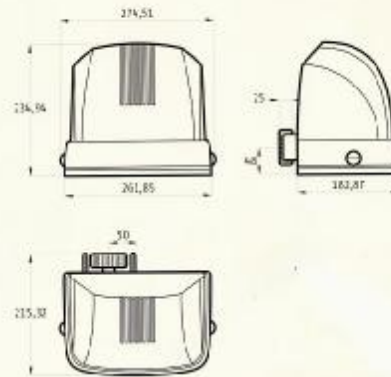

## KEY LOCK OPTIONS

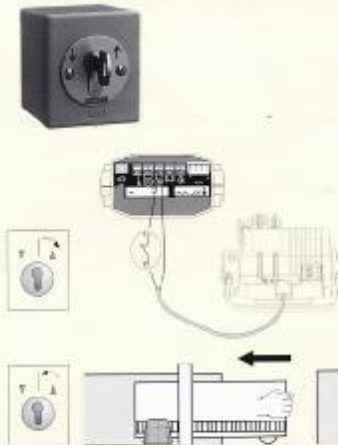

Electro-mechanical locking system  
Ref 1 800 070